

SECTION 1-S5
3/4" = 1'-0"

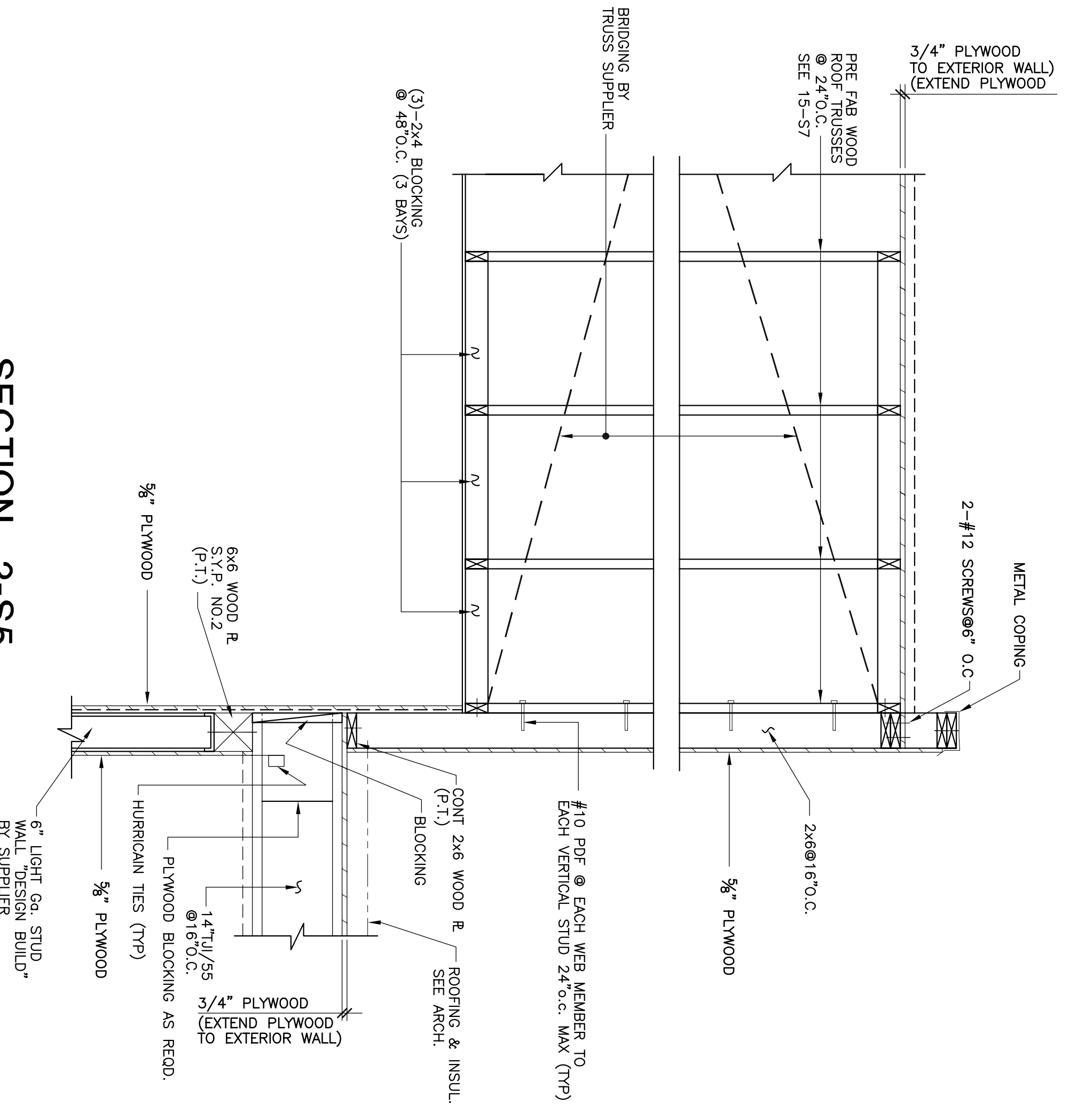

SECTION 2-S5
3/4" = 1'-0"

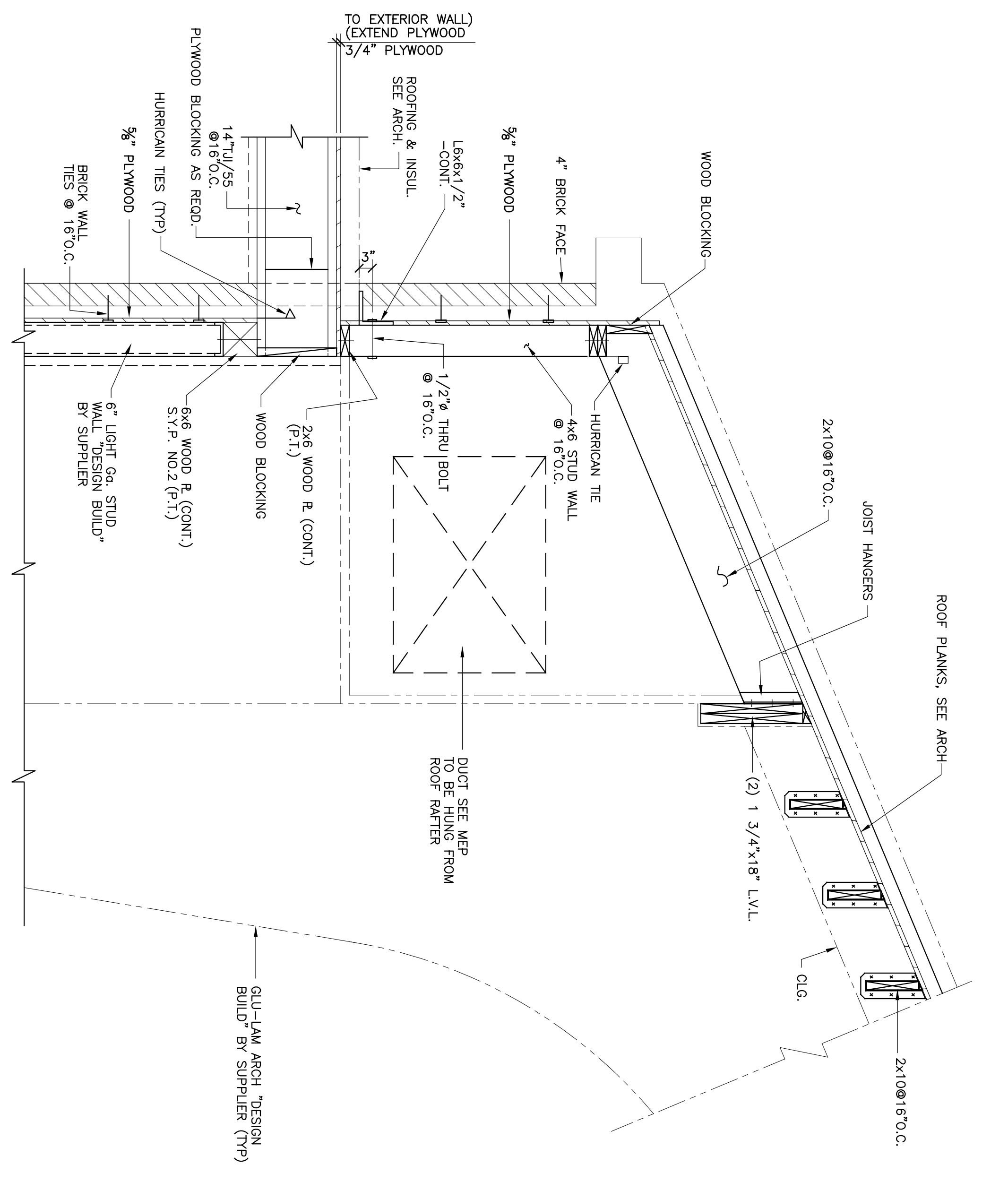

SECTION 3-S5
3/4" = 1'-0"

Date: NOV. 21, 2005
 Scale: AS NOTED
 Drawn: AS NOTED
 Checked:
 File No.
 Drawing No.
55
 of

Philip Aaron Lacy, Architects
 6188 Oxon Hill Road, Suite 303
 Oxon Hill, Maryland 20745
 Phone: 301-567-8223

Project Title:
BETH SHALOM A.M.E. ZION CHURCH
 2501 RITCHIE ROAD
 DISTRICT HEIGHTS, MARYLAND 20735

SECTIONS

Certification:

Consultants:
Tadger Cohen Edelson Assoc.
 CONSULTING STRUCTURAL ENGINEERS

1109 Spring St. Suite #510
 Silver Spring, MD 20910
 (301) 588-1865 (301) 588-1866
 104043.00

Revisions:	Date: