

MEZZANINE LEVEL FLOOR PLAN
SCALE: 1/8" = 1'-0"

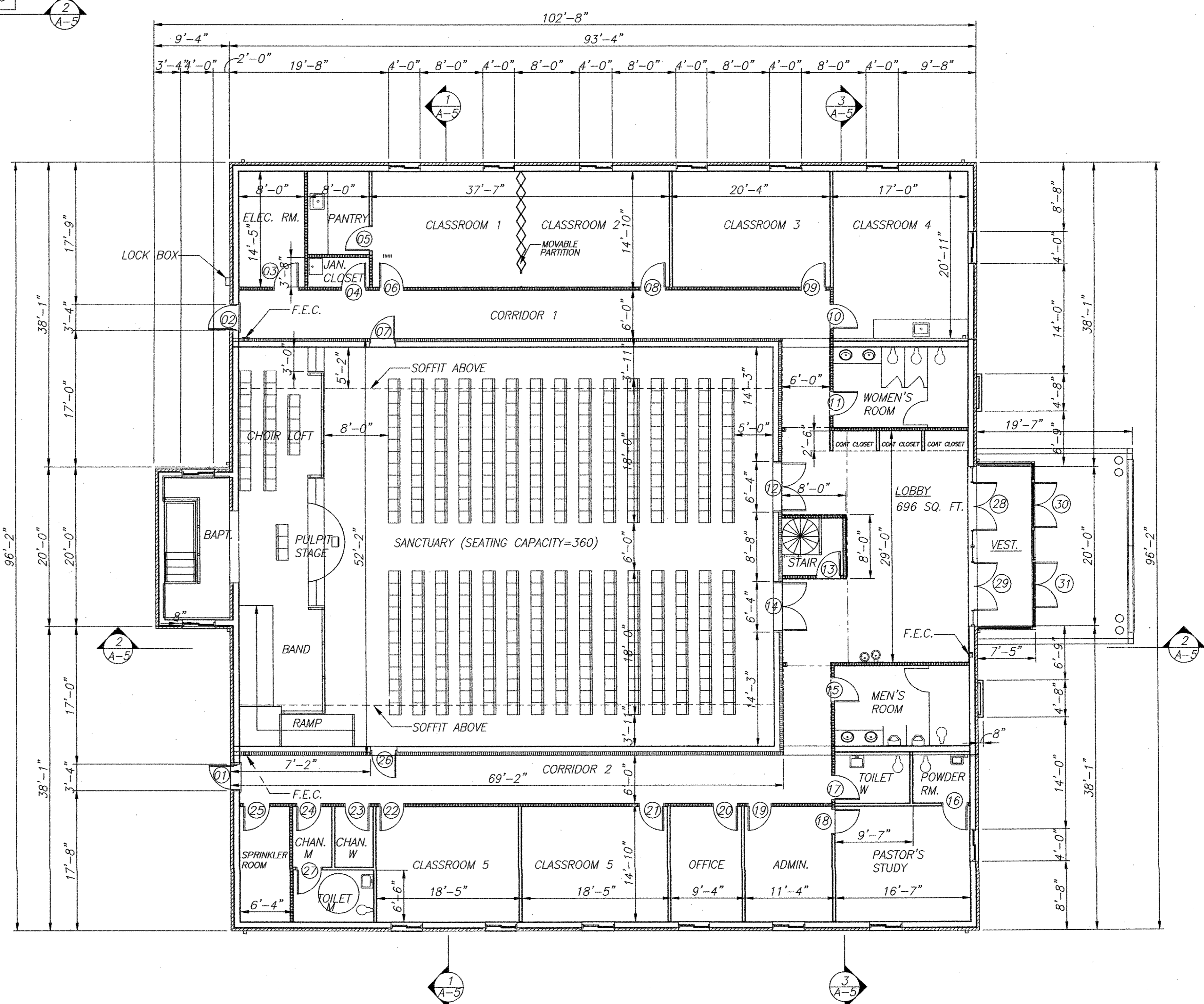

FLOOR PLAN
SCALE: 1/8" = 1'-0" 9,312 SQ. FT.

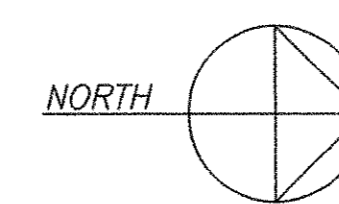

Copyright 2005 Philip Aaron Lacy, Architect. All rights reserved. No portion of this document may be reproduced without written permission.

Date:	
Revisions:	

Consultants:

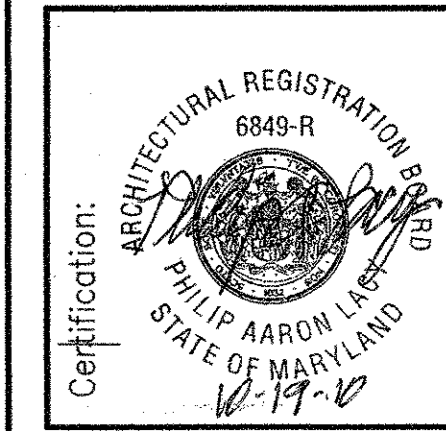

Project Title:
MIRACLE TEMPLE ASSEMBLY OF GOD
14111 ALDERTON ROAD
SILVER SPRING, MARYLAND 20906

Philip Aaron Lacy, Architect
6188 Oxon Hill Road, Suite 303
Oxon Hill, Maryland 20745
Phone: 301-567-8223

Date: OCT. 12, 2010
Scale: 1/8" = 1'-0"
Drawn: FCB
Checked: PAL
File No. MTAC_A01

Drawing No.
A-1
of

Professional Certification: I hereby certify that these documents were prepared or approved by me, and that I am a duly licensed professional architect under the laws of the State of Maryland Architectural License number 6849 with expiration date of 11/18/2011.