

GENERAL ELECTRICAL NOTES

1. SCOPE OF WORK SHALL INCLUDE FURNISHING AND INSTALLING FIRST CLASS WORKING SYSTEMS, TESTED READY FOR OPERATIONS, COMPLETE WITH LABOR, MATERIALS, APPARATUS, TRANSPORTATION AND TOOLS REQUIRED FOR THE INSTALLATION IN CONFORMANCE WITH DRAWINGS AND SPECIFICATIONS.
2. COMPLY WITH THE LATEST EDITION OF THE NATIONAL ELECTRICAL CODE, LOCAL ELECTRICAL CODES, UTILITY COMPANY'S REQUIREMENTS AND ORDINANCES. ALL DEVICES AND MATERIALS NOT SHOWN ON DRAWINGS BUT REQUIRED BY CODE SHALL BE PROVIDED BY CONTRACTOR AT NO ADDITIONAL COST TO THE OWNER. IN THE EVENT OF A CONFLICT THE MOST STRINGENT SHALL GOVERN. SHOULD A CONFLICT ARISE BETWEEN CONSTRUCTION DOCUMENTS AND APPLICABLE CODES, WORK SHALL COMPLY WITH THE REQUIREMENTS OF THE ENFORCING CODE AUTHORITIES.
3. SECURE AND PAY FOR ALL REQUIRED PERMITS AND INSPECTIONS REQUIRED BY AUTHORITIES HAVING JURISDICTION.
4. COORDINATE WORK CLOSELY WITH ALL TRADES.
5. PROVIDE TEMPORARY LIGHTING AND POWER FOR ALL TRADES IN ACCORDANCE WITH PROJECT REQUIREMENTS.
6. KEEP ALL WORK AREAS CLEAN, CLEAN ALL EQUIPMENT, ETC., PRIOR TO FINAL PAINTING AND AT COMPLETION OF PROJECT.
7. ALL CUTTING SHALL BE PAID FOR BY THE ELECTRICAL CONTRACTOR BUT PERFORMED BY THE CONTRACTOR WHOSE WORK IS CUT OR PATCHED.
8. PROVIDE CONDUIT AND WIRING UP TO AND INCLUDING DISCONNECT SWITCH OR JUNCTION BOX FOR MECHANICAL EQUIPMENT UNLESS OTHERWISE INDICATED. STARTERS, CONTROLLERS, CONTROL WIRING AND FINAL CONNECTION TO EQUIPMENT SHALL BE BY OTHERS.
9. ALL CONDUITS SHALL BE RUN CONCEALED ABOVE CEILINGS, IN WALLS AND IN OR BELOW FLOORS. EXPOSED CONDUITS SHALL BE RUN PARALLEL AND PERPENDICULAR TO BUILDING CONSTRUCTION. FINISH SHALL MATCH EXPOSED SURFACES.
10. CIRCUIT NUMBERS SHOWN ON THE DRAWINGS ARE FOR REFERENCE ONLY. IT WILL BE THE CONTRACTOR'S RESPONSIBILITY TO BALANCE LOADS AMONG PHASES IN PANEL BOARDS TO WITHIN 10% OF EACH OTHER.
11. THE CONTRACTOR SHALL MAINTAIN ON SITE ONE SET OF UP-TO-DATE ELECTRICAL DRAWINGS AND MARKUP AS-BUILT RECORDS WHERE REQUIRED ON THESE DRAWINGS. THESE SHALL BE TURNED OVER TO THE OWNER AT THE END OF THE PROJECT.

12. PROVIDE ACCESS DOORS TO ALL ELECTRICAL EQUIPMENT AND DEVICES REQUIRING SERVICE, MAINTENANCE, OPERATION OR ADJUSTMENT WHERE CONCEALED BY INACCESSIBLE FINISHES.
13. CONTRACTOR SHALL BE RESPONSIBLE FOR PROPER SIZING OF ALL MOTOR OVERLOAD DEVICES (HEATERS) IN STARTERS BASED ON ACTUAL NAMEPLATE RATINGS ON THE EQUIPMENT BEING INSTALLED.
14. PROVIDE GROUNDING CONNECTIONS FOR ALL ENCLOSURES, DEVICES & EQUIPMENT PERMANENTLY AND EFFECTIVELY IN ACCORDANCE WITH NEC AND PROJECT SPECIFICATIONS. CONDUCTORS SHALL BE COPPER.
15. ALL EXHAUST FANS SHALL HAVE SWITCHES AND FUSES/STARTERS PROVIDED. PROVIDE AND WIRE ALL SWITCHES AND FUSES/STARTERS.
16. JUNCTION BOXES AND PULL BOXES SHALL BE INSTALLED WHEREVER REQUIRED FOR A COMPLETE INSTALLATION OF THE ELECTRICAL WORK AND SHALL BE SIZED PER NEC. DO NOT INSTALL BACK-TO-BACK JUNCTION BOXES ON ANY PARTITION UNLESS OTHERWISE NOTED.
17. PROVIDE ELECTRICAL SERVICE AND CONNECTION FOR EVERY FIXTURE, APPLIANCE OR ITEM OF EQUIPMENT REQUIRING SAME, WHICH IS SHOWN ON ANY CONTRACT DRAWING UNLESS SUCH CONNECTION IS OTHERWISE NOTED.
18. INSTALL EQUIPMENT IN ACCORDANCE WITH THE MANUFACTURER'S RECOMMENDATIONS AND CONDITION FOR WARRANTY AND GUARANTEE. PROVIDE ALL ACCESSORIES REQUIRED FOR A COMPLETE AND SATISFACTORY INSTALLATION READY FOR CONTINUOUS USE.
19. SUPPLIED, REGARDLESS OF TRADE, PRIOR TO ROUGH-IN, VERIFY HORSEPOWER AND NAMEPLATE RATINGS OF EQUIPMENT AND COORDINATE CIRCUIT CHARACTERISTICS TO PROVIDE CODE CONFORMANCE.
20. WIRING, UNLESS OTHERWISE SPECIFIED, SHALL BE ARMORED(C), METAL-CLAD(MC) AS PERMITTED BY CODE. ADEQUATELY SIZED AND INSTALLED ACCORDING TO THE LATEST EDITION OF THE NATIONAL ELECTRICAL CODE AND LOCAL ORDINANCES. WIRE SIZES ARE FOR 75° C THW COPPER UNLESS OTHERWISE NOTED. MINIMUM WIRE SIZE SHALL BE #12 AWG. (b) CONDUCTORS SHALL BE SOLID UP THROUGH #10 AWG.
21. (a) ALUMINUM SHALL NOT BE USED EXCEPT WHERE IT IS SPECIFICALLY DESIGNATED FOR FEEDERS ON DRAWINGS.

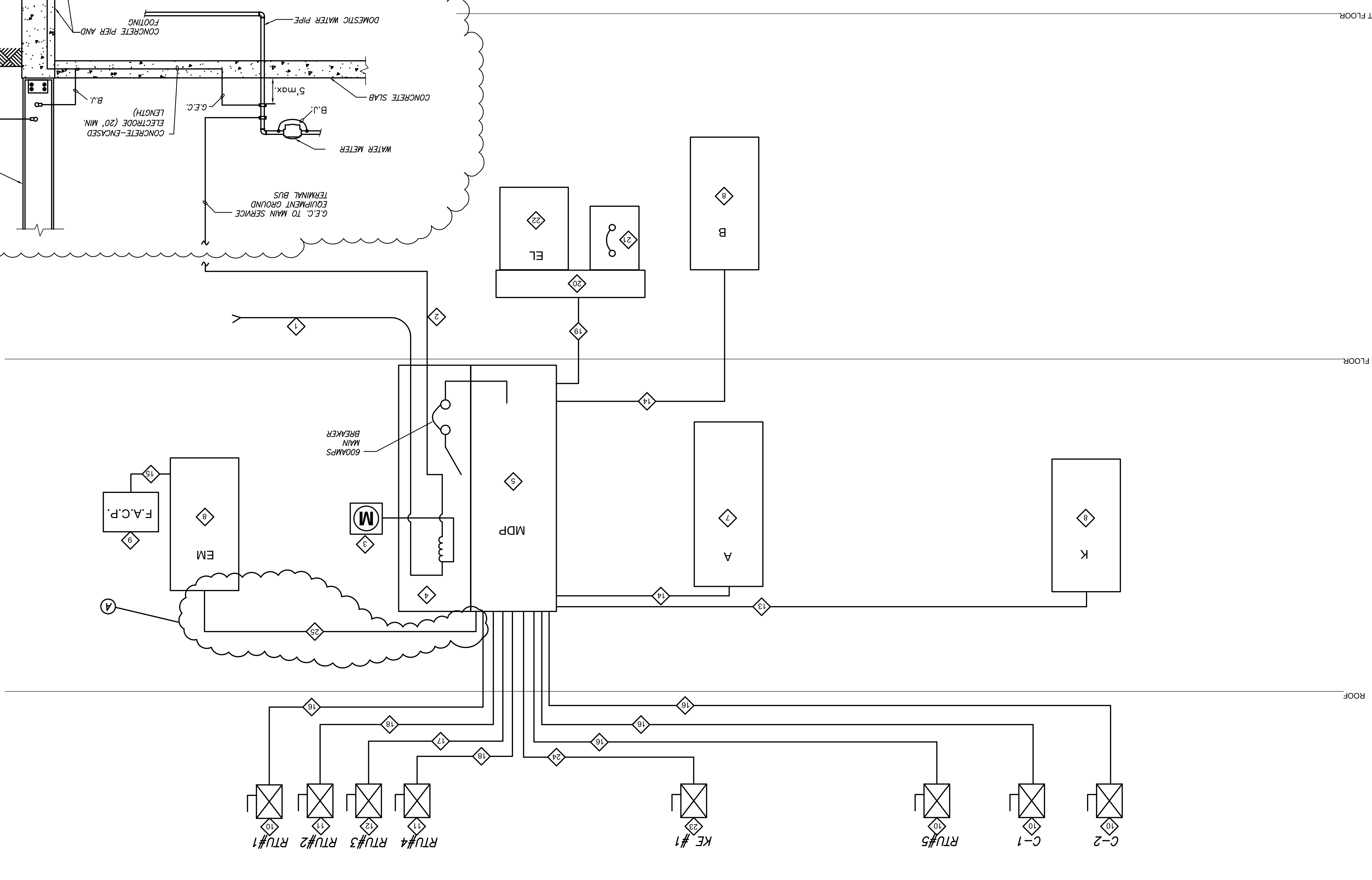

POWER RISER NOTES

- ◇ NEW INCOMINGSERVICE FROM UTILITY CO.
- ◇ #3/0 G.E.C. TO COLD WATER PIPING, BUILDING STEEL AND 3/4"x10"-0" LONG COPPER-CLAD GROUND ROD.
- ◇ UTILITY METER
- ◇ CT CABINET
- ◇ MAIN DISTRIBUTION PANEL - 600A, 120/208V, 3Ø, 4W
- ◇ EMERG. DISCONNECT SWITCH - 100A, 3P, 240V
- ◇ FLOOR PANELBOARD - 225A, 120/208V, 3Ø, 4W
- ◇ KITCHEN PANELBOARD - 100A, 120/208V, 3Ø, 4W
- ◇ FIRE ALARM CONTROL PANEL
- ◇ DISCONNECT SWITCH - 60A, 3P, 240V, 3R (F--40A)
- ◇ DISCONNECT SWITCH - 200A, 3P, 240V, 3R (F--110A)
- ◇ DISCONNECT SWITCH - 100A, 3P, 240V, 3R (F--70)
- ◇ KITCHEN PANEL FEEDER - 4 #1+6G IN 2" C
- ◇ FLOOR PANEL FEEDER - 4 #4/0+6G IN 2-1/2" C
- ◇ F.A.C.P. FEEDER - 2 #12+12G IN 3/4" C
- ◇ ROOF TOP UNITS FEEDERS - 3 #3+6G IN 1 1/4" C
- ◇ ROOF TOP UNITS FEEDERS - 3 #3+6G IN 1 1/4" C
- ◇ ROOF TOP UNITS FEEDERS - 3 #1/0+6G IN 1 1/2" C
- ◇ ELEVATOR FEEDER - 4 #3+8G IN 1 1/4" C
- ◇ ELEVATOR WIRE TROUGH (SIZED PER N.E.C.)
- ◇ ELEVATOR SHUNT TRIP BREAKER (SIZED PER MANUFACTURER'S SPECIFICATION)
- ◇ ELEVATOR PANEL
- ◇ DISCONNECT SWITCH - 30A, 2P, 240V, 3R (F--20A)
- ◇ KITCHEN EXHAUST FAN FEEDER - 2 #10+10G IN 3/4" C
- ◇ EM PANEL FEEDER - 4 #10+10G IN 3/4" C

ABBREVIATIONS

- G.E.C. - GROUNDING ELECTRODE CONDUCTOR
- B.I. - BUILDING JUMPER

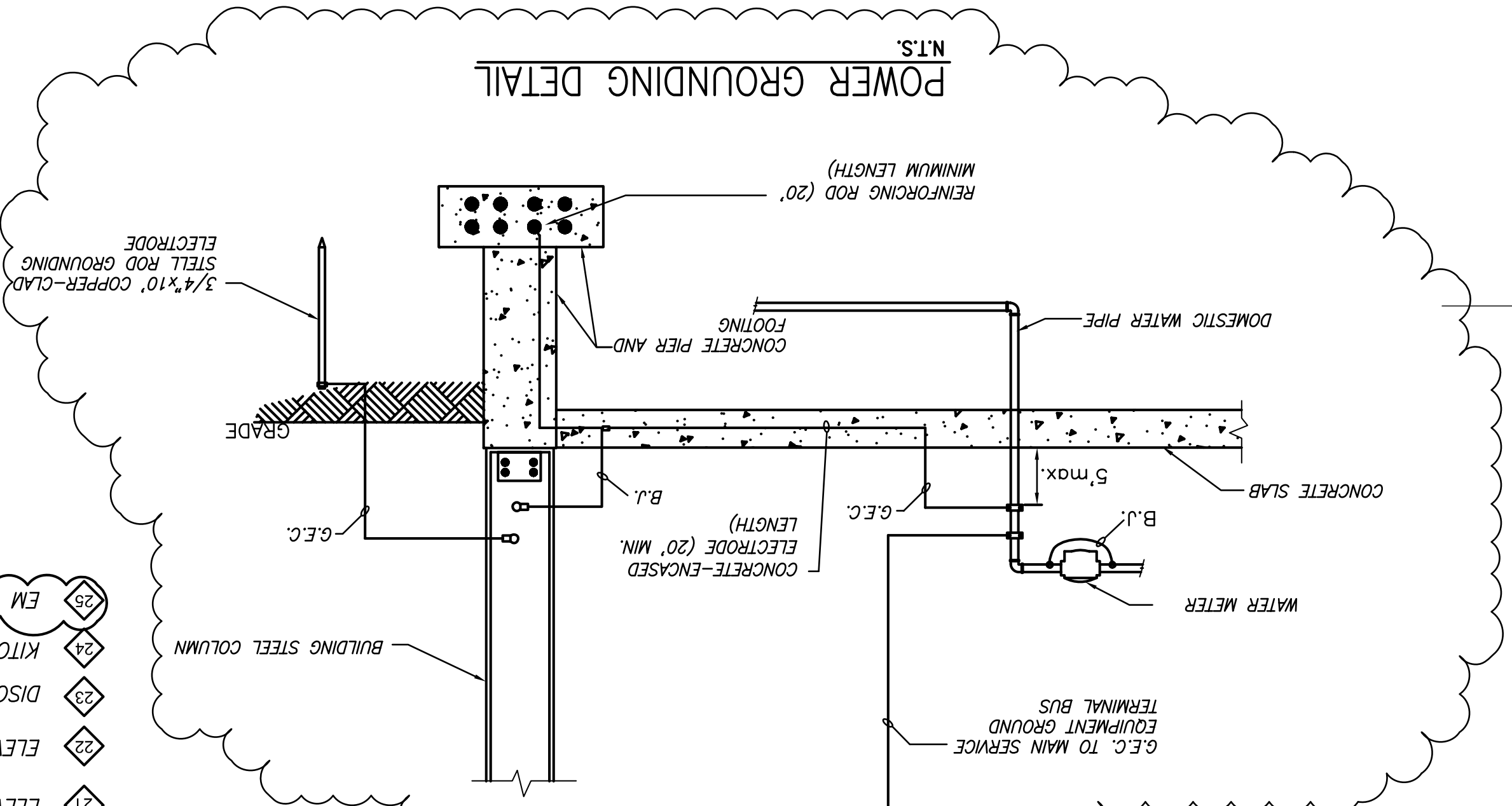

POWER RISER DIAGRAM

N.T.S.

POWER GROUNDING DETAIL

N.T.S.

Drawing No. **F-6**

File No. **BETH_A01**

Checked: **C.FORD**

Drawn: **PAL**

Scale: **1/8"=1'-0"**

Date: **NOV. 29, 2005**

Project Title: **BETH SHALOM A.M.E. ZION CHURCH**
 2501 RITCHIE ROAD
 DISTRICT HEIGHTS, MARYLAND 20735

Engineers: **CHARLES FORD & ASSOCIATES**
 CONSULTING - ENGINEERS & PLANNERS
 4325 GREENBAY AVE. N.W. WASHINGTON, D.C. (202) 722-4190

Revisions:	Date:
① PERMIT	10-3-07
② PERMIT	07-8-08
③ PERMIT	11/06/08

Philip Aaron Lacy, Architect
 4013 21st. Place
 Temple Hills, Maryland 20748
 Phone: 301-894-7979

ELECTRICAL SCHEDULES & NOTES