

WALL SECTIONS (CONTINUED)

SCALE: $\frac{1}{2}'' = 1'-0''$

PARTITION DETAILS

SCALE: $1'' = 1'-0''$

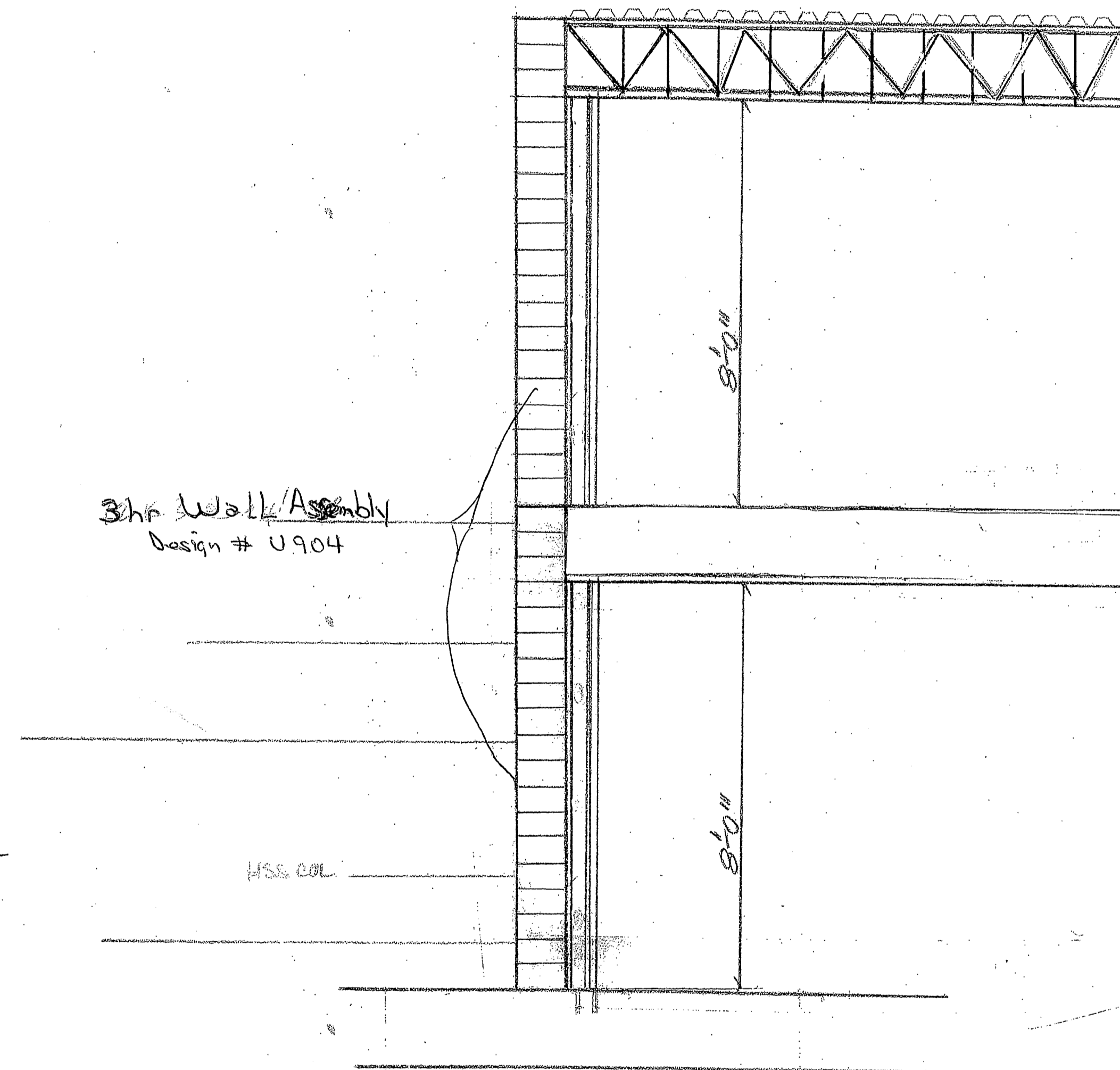
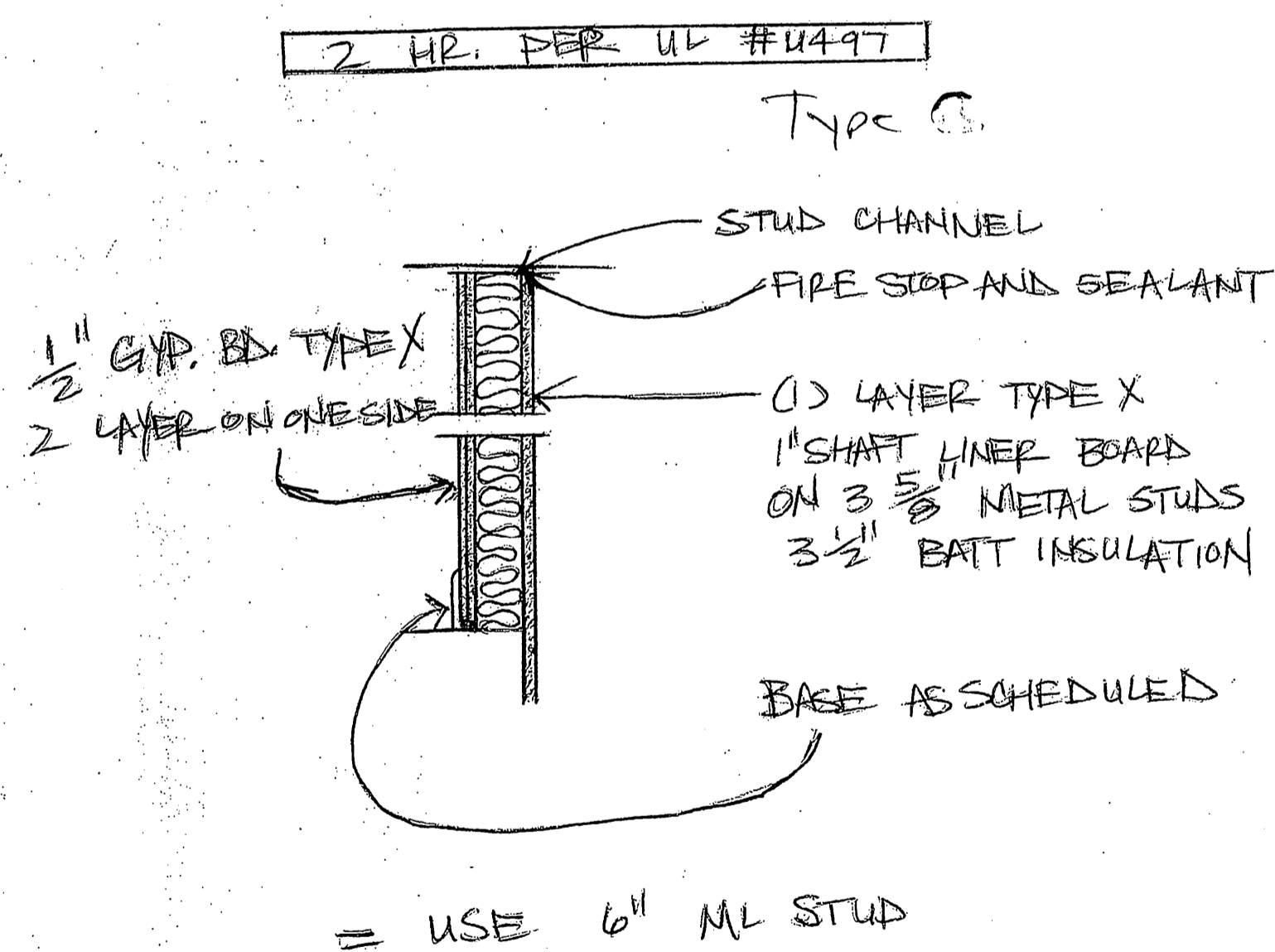
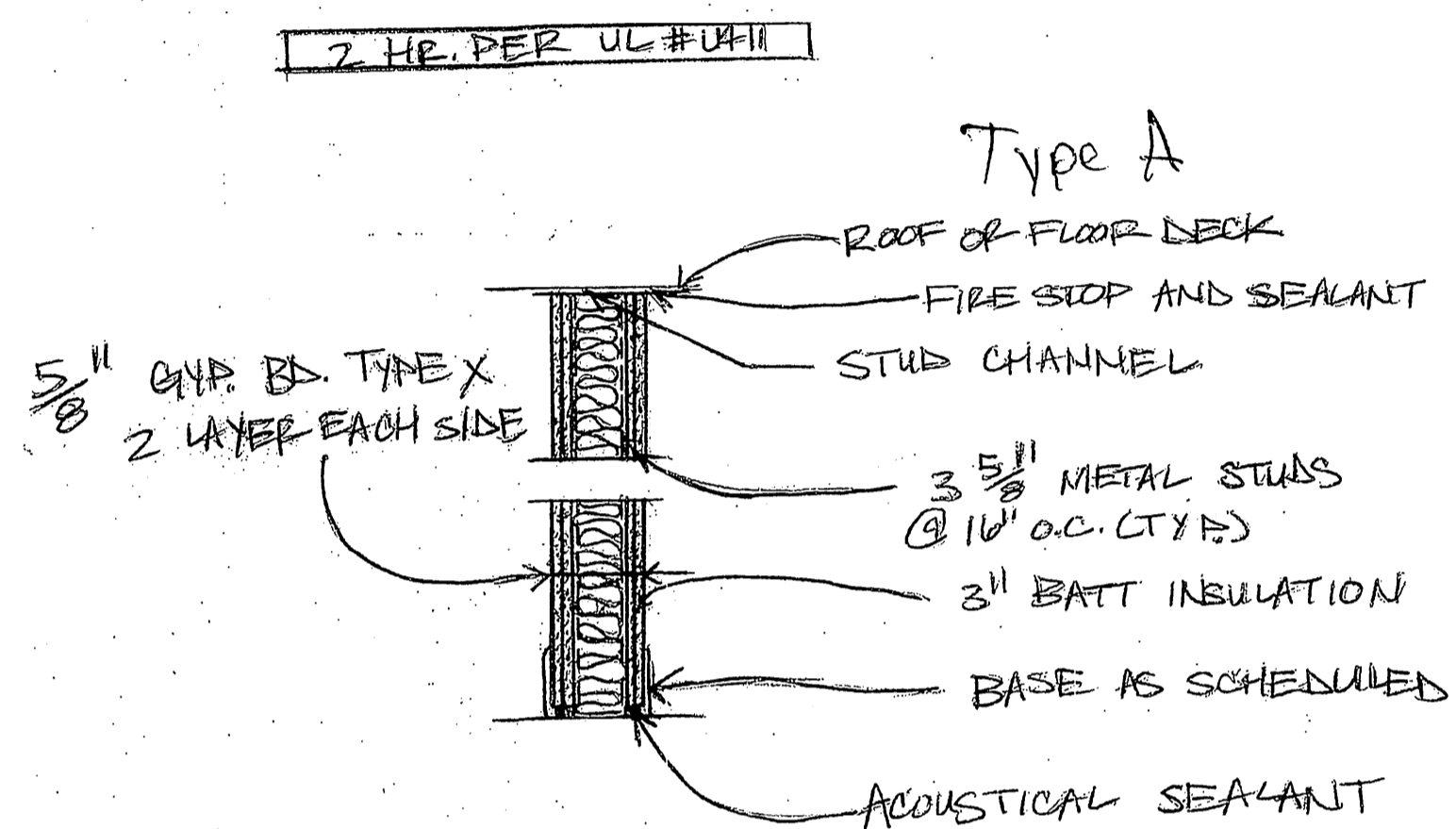

866 FIRE RESISTANCE DIRECTORY

FIRE RESISTANCE RATINGS (BXUV)—Continued

Design No. U904

Assembly Rating—3 Hr.

Bearing or Nonbearing Wall

Labels: 3, 2, 4, 1 Horizontal Section, 7-5/8" MIN.

- Concrete Blocks—Various designs. Classification C-3 (3 hr). See Concrete Blocks category for list of eligible manufacturers.
- Mortar—Blocks laid in full bed of mortar, nom. 3/8 in. thick, of not less than 2-1/4 and not more than 3-1/2 parts of clean sharp sand to 1 part Portland cement (proportioned by volume) and not more than 50 percent hydrated lime (by cement volume). Vertical joints staggered.
- Mortar Mixture—(Alternate to Mortar—item 2)—not more than 130 lbs of sand and 5 gal of water to 78 lbs (one bag) of mortar mixture. Cement Laboratories, Inc.
- Portland Cement Stucco or Gypsum Plaster—Add 1/2 hr to Classification if used.
- Loose Masonry Fill—if all core spaces are filled with loose dry expanded slag, expanded clay or shale (Rotary-Kiln Process), water repellent vermiculite masonry fill insulation, or silicone treated perlite loose fill insulation add 1 hr to Classification.

*Bearing the UL Classification Marking

$\frac{1}{2}'' = 1'-0''$

WALL SECTIONS (CONTINUED)

REVISION #3	DATE
OCTOBER 31, 2007	

SHEET NO.

A.10

